

M8x25mm BOLT WITH NUT & WASHER 5 Nos. IN EACH JOINT OF THE SECTIONS

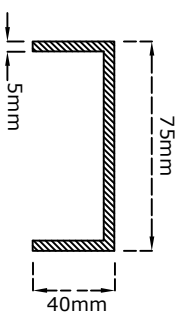

DETAIL at 'D'

PIN HOLE (DRIVE HOLE)
MIN 2 PIN HOLES REQUIRED PER FLANGE
DIA = 65mm (5mm thick)
LENGTH = 70mm

BARREL IN MAXIMUM FOUR SEGMENTS

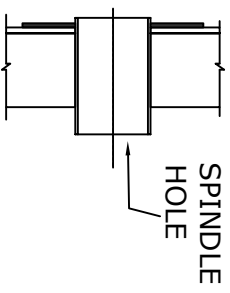

SPINDLE HOLE

NOTE :

- (i) Flanges shall have non corrosive primer coat and enamel paint .
- (ii) Washers are required on all bolts.
- (iii) Barrel and inner surface of flange shall have water proof protective HDPE sheet.
- (iv) Medium grade Craft/Crepe/Polythene Paper shall be used in between the Layers of Conductor.
- (v) Tolerance overall : +5mm.
- (vi) Tolerance on sheet metal : +0.1mm.
- (vii) Tolerance on other M.S items : +3mm.
- (viii) Tolerance on thickness for other M.S items : +0.5mm.
- (ix) Tolerance on bush : +2mm.
- (x) All dimensions are in mm
- (xi) All mild steel shall conform to IS-2062

Name of the Parts	Material Specification	Quantity	Dimensions
1 OUTER RING	M.S. PLATE	2	63x8 mm (FLAT RING)
2 TIE ROD	M.S. ROD	8	18 mm DIA
3 CENTRE BUSH	M.S. PIPE	2	105 mm IDx115 mm OD
4 INNER RING	M.S. PLATE	2	100x6 mm
5 FLANGE	H.R. SHEET	Max 3 CORRUGATED SHEETS PER FLANGE	1.6 mm THICK (min 36 nos. of corrugations)
6 BARREL SHEET	H.R. SHEET	Max 4 SEGMENTS	2.5 mm THICK
7 CROSS ARM	MILD STEEL	4	100mmx70mm, 6mm THICK OR MS CHANNEL 125mmX65mmX6, 6mm (LC125)
8 FRAME SIZE(FOR MARKING)			250mmx400mm (APPROX)
9 SOLID PP SHEET	POLY PROPYLENE		3 mm THICK (min)

STANDARD DRAWING

STANDARD CONDUCTOR LENGTH	LAPWING	BERSIMIS	MOOSE	SNOWBIRD	ZEBRA	PANTHER
L in Meters	1800	2100	2400	2600	3000	3500

REVISION

REV. No	DESCRIPTION	CHGD	REVMG	APPD	CHECKED	RETRYMG	APPROVED
1	Note no. 4 added.						
2	Standard Length & PP Sheet Thickness Modified.						

STANDARD DRAWING

FOR ACSR/AAAC/AL59 CONDUCTOR



शक्ति ग्रिड कॉर्पोरेशन ऑफ इंडिया लिमिटेड
POWER GRID CORPORATION OF INDIA LIMITED
(A Government of India Enterprise)